

Selbourne Playground // Concept Design Overview ~ Updated February

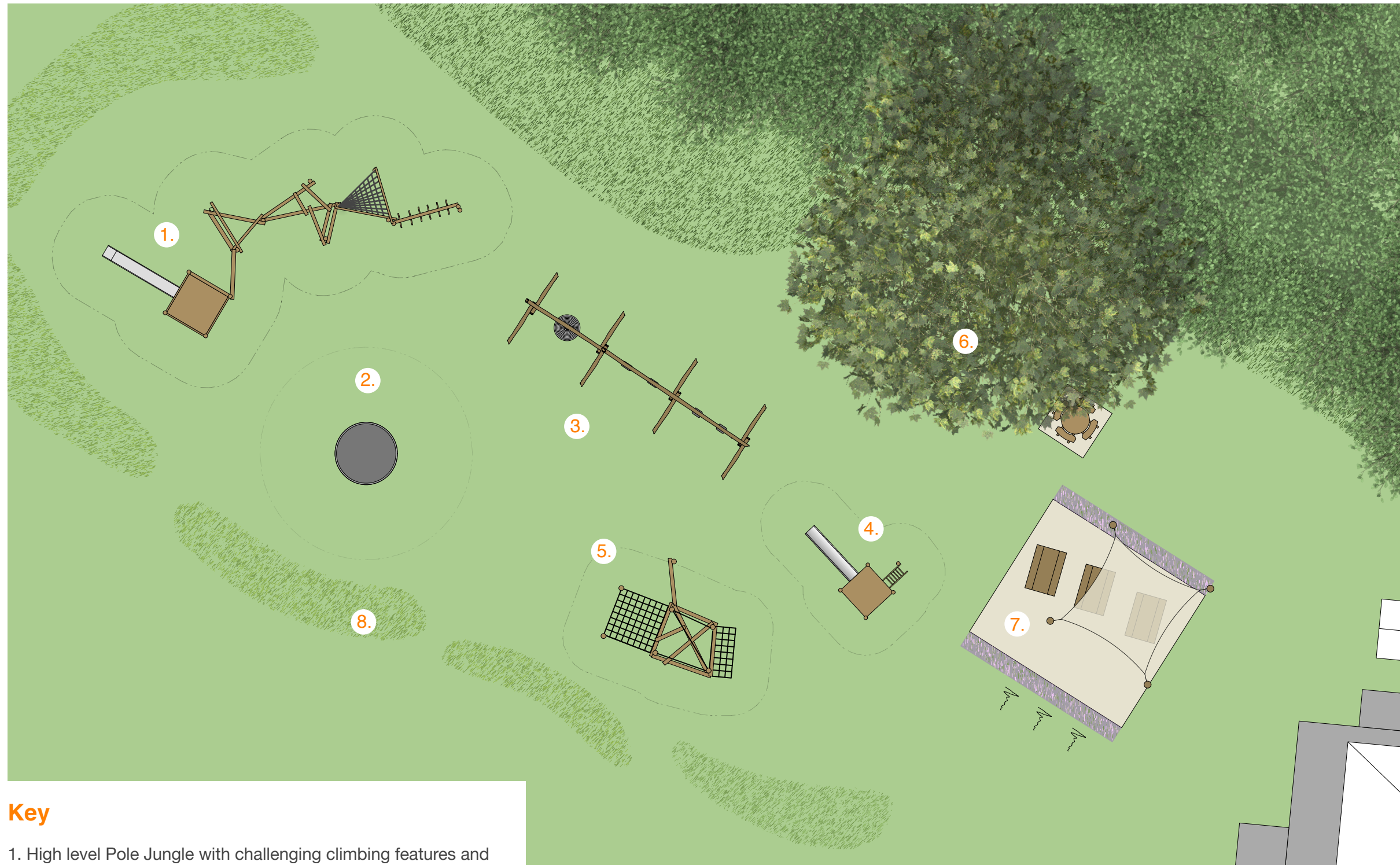

We have suggested grass mats for all safety surfacing as it is cost effective and low maintenance. It also retains the natural look and feel when the grass grows through.

* The tall robinia poles of these items will be carved to reflect the wildlife theme. Including stalks of wheat, harvest mice, wildflowers, insects, birds and of course Timothy the tortoise.



NB. All our play equipment adheres to safety standard BS EN1176/77 and we provide the client with a ROSPA Post Installation Inspection. All images are purely inspirational to demonstrate similar play outcomes, quality of workmanship and material choices.

Scale 1:175 @ A3

Key

1. High level Pole Jungle with challenging climbing features and tower with stainless steel slide.*
2. A 2.5m wide spinning disc also sits within this space, but can be enjoyed by all ages and abilities.
3. Double swing set with two junior swing seats, two toddler seats and a basket swing caters for all ages and abilities.
4. The area to the right is dedicated to younger children, located close to the seating areas. A Mouse House den provides role play opportunities, along with climbing and sliding.*

5. A low level climbing structure with scramble nets and balance beams.*

6. The impressive Plane tree is a focal point of the space and provides a shaded social area.

7. The existing paved area is retained to provide an all weather seating space. A sail shade can be suspended between the existing poles to provide shade on sunny days.

8. Relaxing the mowing regime around the boundary of the play space would help to embed it into the landscape, whilst adding to the wildlife theme.

CLIENT Selbourne Parish Council		ISSUE DATE 17/02/2023
DRAWING NUMBER 220818SEL	SHEET NUMBER 01	REVISION 02
DRAWN BY JN	